

# BINDING POSTS

Designers' Choice



All Keystone binding posts are designed to prevent accidental contact with current carrying parts. They feature a "limited opening" captivated head to insure safety. Ideal for audio circuitry, R.F. Circuitry, oscilloscopes, power supplies and various other applications.

These multi-purpose binding posts feature high current rating, captivated heads and anti-rotation stud mounting.

**NOTE:** Binding Posts accept .175" Banana Plugs, .080" Tip Plugs, Spade Lugs, Alligator Clips, Wires and EZ hooks.

## STANDARD BINDING POST

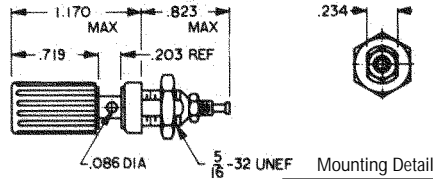
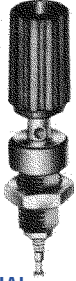

### MATERIAL

**Stud:** Brass per QQ-B-626  
**Finish:** Silver Plate  
**Insulation:** Nylon

### RATINGS

**Current:** 15 Amps  
**Breakdown voltage:** 5700 VRMS  
**Stud to panel capacitance:** 3.3 pF Nominal

FOR PANELS UP TO .281" THICK

| CAT. NO. | COLOR |
|----------|-------|
| 7004     | RED   |
| 7005     | BLACK |

## MINIATURE FLUTED HEAD

Rated 15 Amperes, 1000 VAC Working. Stud: Brass per ASTM B-16 Nylon Insulation. Choice of Gold or Tin Plate.

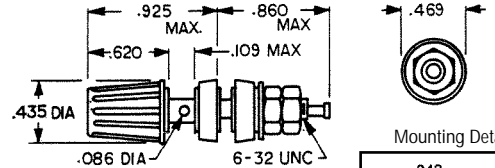

### GOLD PLATE

| CAT. NO. | COLOR |
|----------|-------|
| 7012     | RED   |
| 7013     | BLACK |

### TIN PLATE

| CAT. NO. | COLOR |
|----------|-------|
| 7014     | RED   |
| 7015     | BLACK |

## ECONOMY BINDING POST

Rated 15 Amps, 1000 VAC working.

**Stud:** Brass per ASTM -B16

**Finish:** Nickel Plate

**Insulation:** Nylon

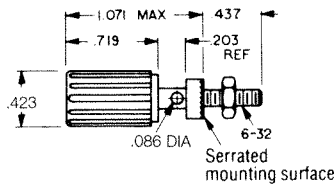
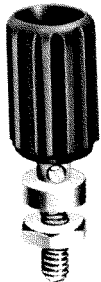

FOR PANELS UP TO .313 THICK

| CAT. NO. | COLOR |
|----------|-------|
| 7006     | RED   |
| 7007     | BLACK |

## STANDARD HEX HEAD

Rated 30 Amperes, 1000 VAC Working. Nylon Insulation. Stud: Brass per ASTM B-16. Choice of Gold or Tin Plate.

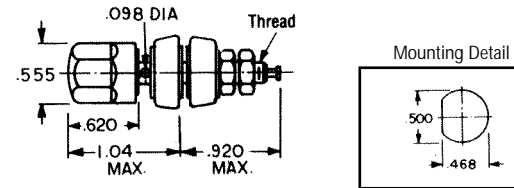

### GOLD PLATE

| CAT. NO. | TH'D  | COLOR |
|----------|-------|-------|
| 4096     | 8-32  | RED   |
| 4097     | 8-32  | BLACK |
| 7016     | 10-32 | RED   |
| 7017     | 10-32 | BLACK |

### TIN PLATE

| CAT. NO. | TH'D  | COLOR |
|----------|-------|-------|
| 4091     | 8-32  | RED   |
| 4092     | 8-32  | BLACK |
| 4093     | 10-32 | RED   |
| 4094     | 10-32 | BLACK |

## STANDARD DUAL HEAD

Rated 30 Amperes, 1000 VAC working. Studs: Brass per ASTM B-16. Nylon Insulation. Mounts in .500 holes on .750 centers. Supplied with: 1 Red-1 Black head. Choice of Gold or Tin Plate.

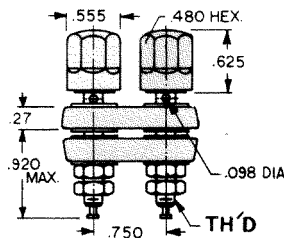
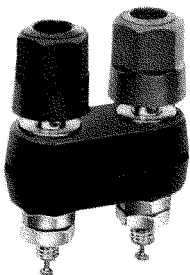

### GOLD PLATE

| CAT. NO. | THREAD |
|----------|--------|
| 4108     | 8-32   |
| 4109     | 10-32  |

### TIN PLATE

| CAT. NO. | THREAD |
|----------|--------|
| 7018     | 8-32   |
| 7019     | 10-32  |

## DUAL BANANA PLUGS

Spring: Nickel Silver. Body: Brass per ASTM B-16. Finish: Nickel Plate. Insulation: Molded Nylon. .750 Mounting Centers. Breakdown: 3500 VRMS

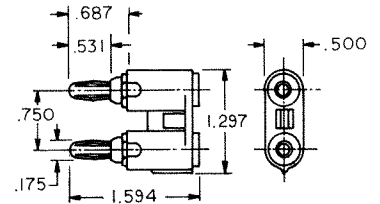
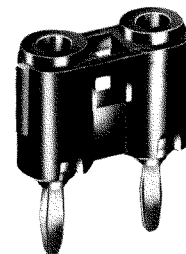

### SOLDERLESS WITH SET SCREW

| CAT. NO. | COLOR |
|----------|-------|
| 6088     | RED   |
| 6089     | BLACK |